

AW600

TECH GUIDE

SOLID WALL SYSTEM



info@amronarchitectural.co.uk

01795 228 583

9-10 The Foundry Business Park,
Seager Road, Faversham,
Kent, ME13 7FD

System Overview



Hidden Fixings

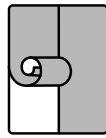

Internal Walls



Variable

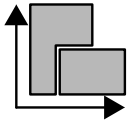

**MAX. 1000 x
3000 mm**

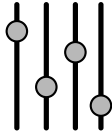

**Customisable
Options**



**Integrated
services**



**Dependent
on Finish**

Finishes Range

We offer any RAL colours or bespoke powder coat finishes, as well as, decorative plated finishes. Exterior finishes are also available.



Powder Coat



PVD



**Decorative
Plated Finish**



Anodised

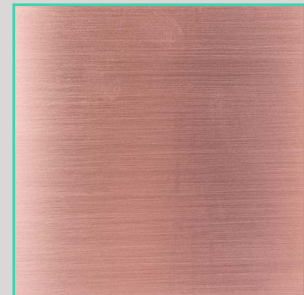
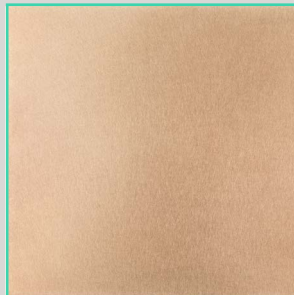

To find out more about the colours in our range, please contact our team.

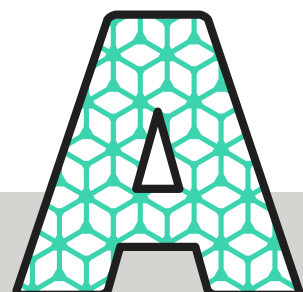

Technical Details

Key

- 1** Metal Panel
- 2** Backing Panel
- 3** Z-Hook Wall Bracket
- 4** Countersunk Screw

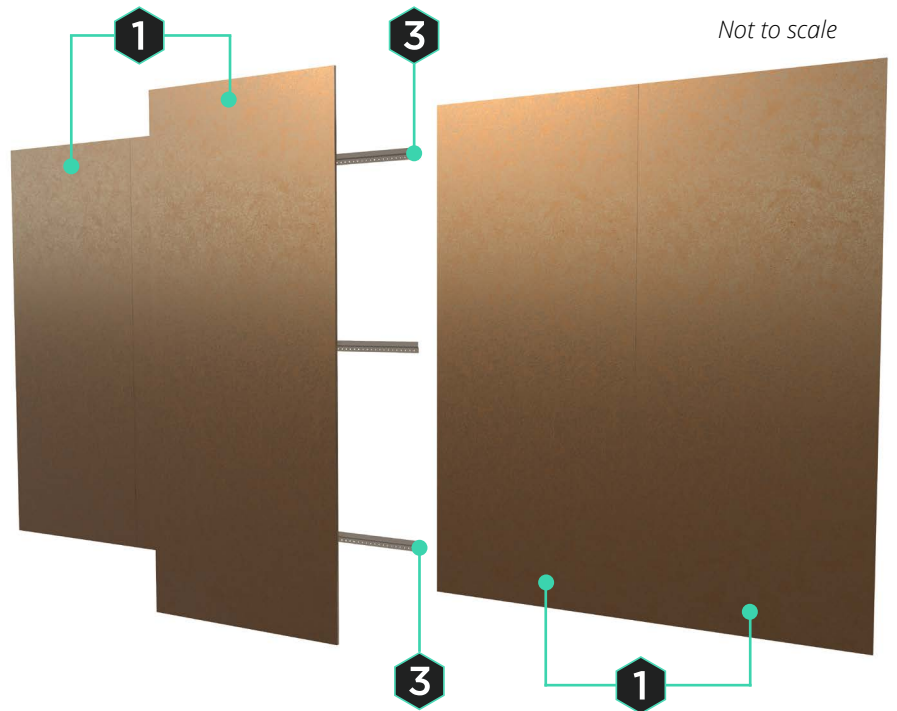

Side View Detail

Not to scale

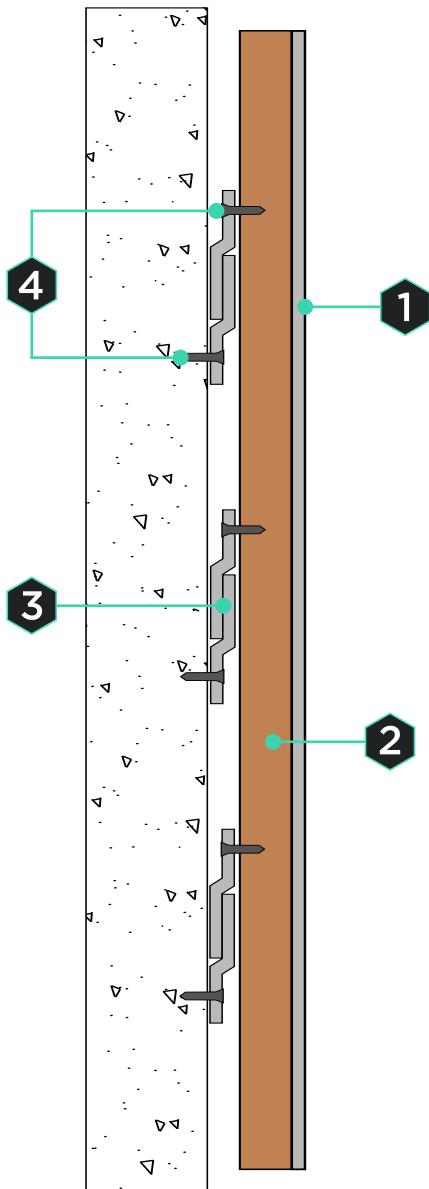

Side View: Mounting detail

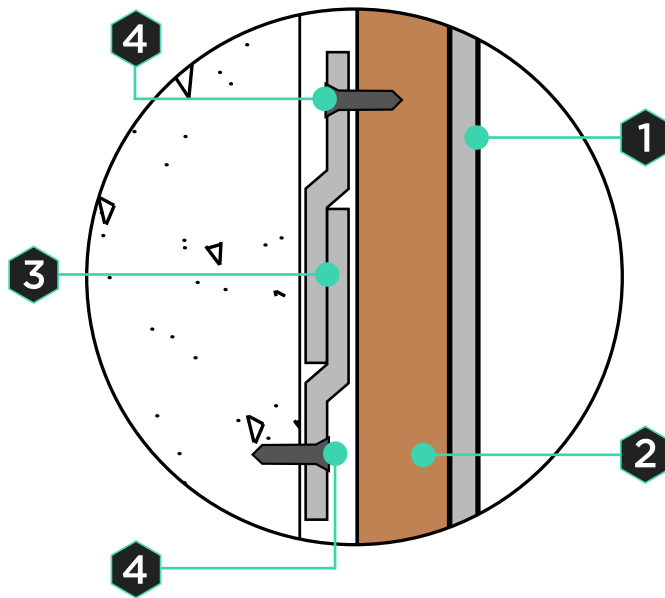

Contact our Technical team on info@amronarchitectural.co.uk if you need more details on our systems.

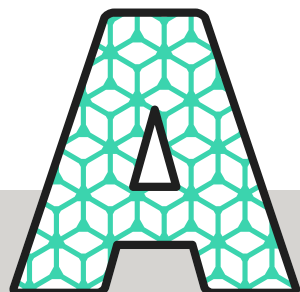

Configurations

Single Run

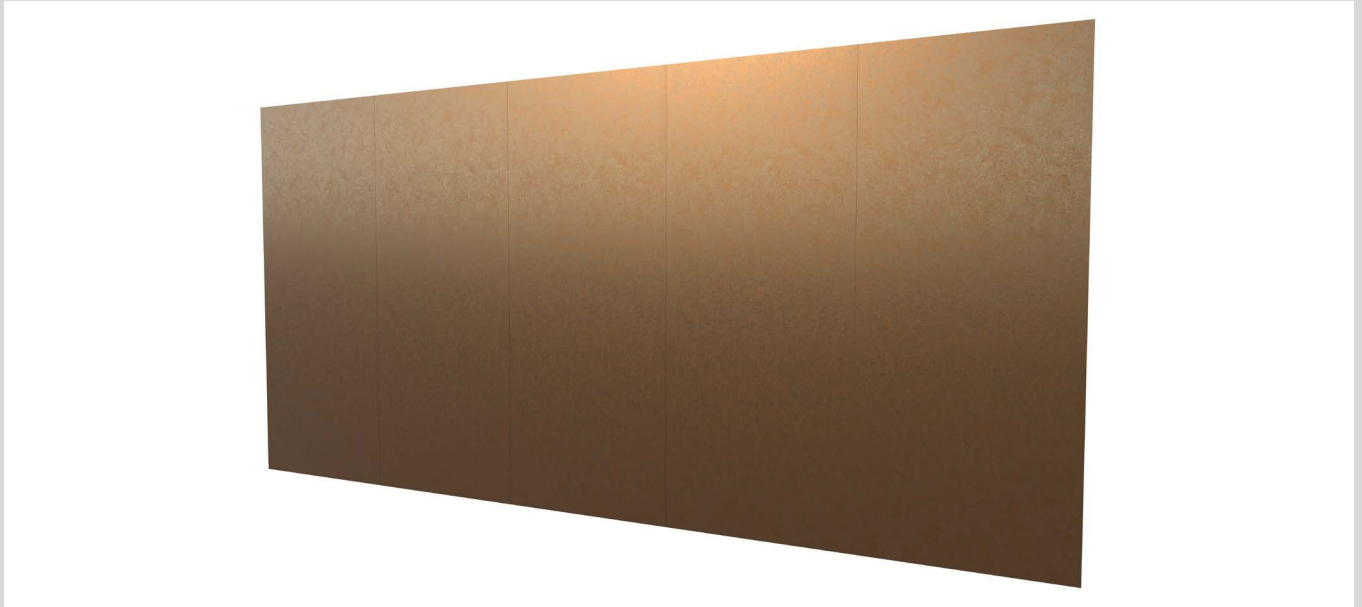

Varying Sizes

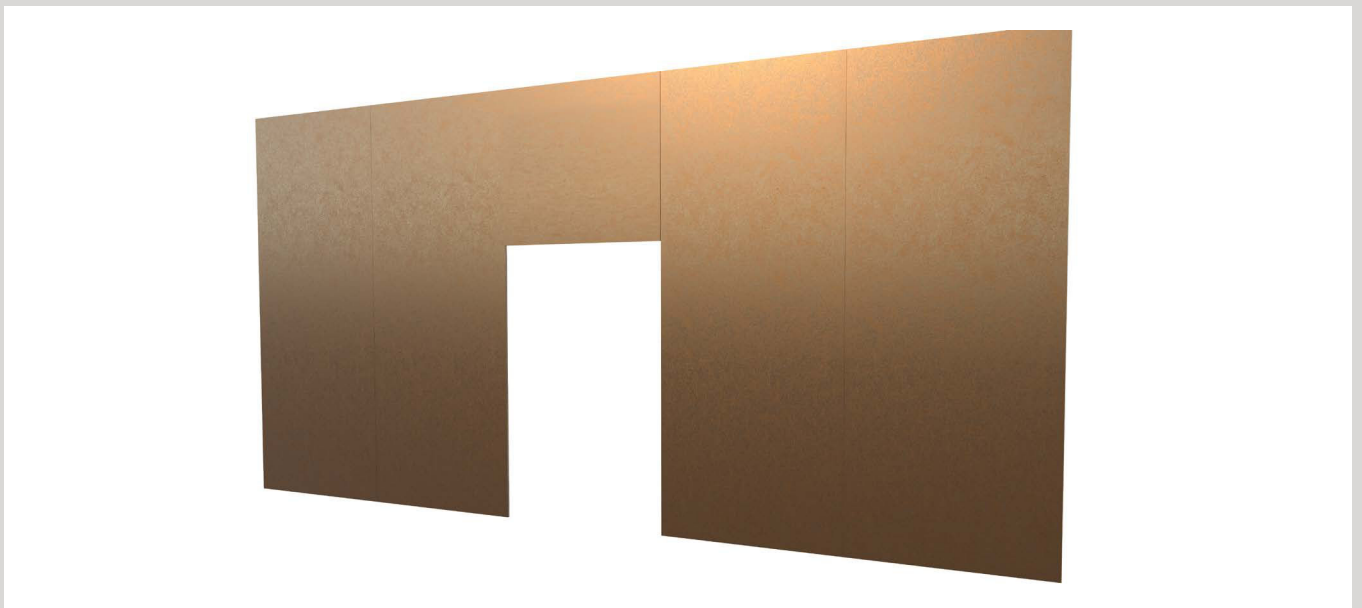

Contact our Technical team on info@amronarchitectural.co.uk if you need more details on our systems.

